



---

## Bathing establishment Fact Sheet

Name of bathing establishment	BAGNO DELFINO
Address	Byle Cristoforo Colombo 68
City	Marina di Carrara (Ms)
Contacts	0585 788423 / 347 4767590
Website	<a href="https://www.hoteldelfinomarinadicarrara.com/">https://www.hoteldelfinomarinadicarrara.com/</a>

**TESTED BY:** Handy Superabile - Social Promotion Association in summer 2024

**Please note** The following information refers to the date of verification shown at the bottom of each sheet. **The Association** is not responsible for any significant changes made by the property after the visit.



---



## Summary

Bathing establishment Fact Sheet .....	1
Arrival at the property.....	3
Private/public parking.....	3
Pathway from the car park to the main entrance .....	3
Reception.....	4
Bar/restaurant .....	5
Internal Pathways and common services.....	6
Internal Pathways .....	6
Toilet and shower for guests with reduced mobility .....	6
Changing room .....	8
Beach.....	9
Children's play area .....	10
Swimming pool .....	11
Medical practices/healthcare facilities.....	12



## Arrival at the property

### Private/public parking

Presence of private parking	YES
Type of private parking fund	Dirt and gravel
Presence of parking space reserved for people with disabilities in the private parking lot	YES
Public parking nearby	YES
Type of public parking floor	asphalt
Presence of parking space reserved for people with disabilities in the public parking lot	YES
	

### Pathway from the car park to the main entrance

Pathway from the car park to the entrance	by ramp length 1.74 m, width 3.8 m slope 4 %
There are indicators and tactile maps	NO



Useful width of door/entrance gate	Above 90 cm
	

**Reception**

Umbrella booking system	<input type="checkbox"/> By the web <input checked="" type="checkbox"/> By phone <input type="checkbox"/> On-site
Presence of multilingual staff	YES
Presence of plant map with legend of services available	NO
Presence of visuo-tactile map	NO
Bulletin board/information panels with an average height of 130 cm in a well-lit area and a font size of at least 14 dpi with a contrast ratio greater than 4.5:1	YES
The staff followed a training course on welcoming people with different disabilities	YES



**Bar/restaurant**

Type of venue	Bar/restaurant
Access to the premises	flat
Useful width of door/entrance gate	Above 90 cm
Bar bench	Above 100 cm
Types of tables	with central support that can hinder approaching the wheelchair
Space under floor tables	Above 65 cm
Multilingual menu	NO
Large print menus	YES
Braille menu	NO
Table service for people with disabilities	YES
Availability of gluten-free food	<input type="checkbox"/> bread <input type="checkbox"/> pasta <input type="checkbox"/> biscuits <input checked="" type="checkbox"/> ice cream <input type="checkbox"/> Pre-packaged foods

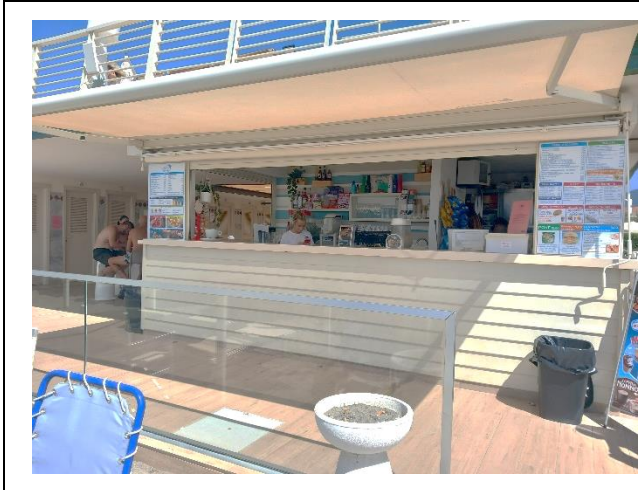



## Internal Pathways and common services

### Internal Pathways

Indicate whether the pathways connecting the entrance to the beach are flat or with ramps in addition to those already described



Obstacle-free paths



### Toilet and shower for guests with reduced mobility

Number of <b>accessible toilets</b> for guests with reduced mobility	1
Access to the premises	flat
Usable width of the entrance door	Above 90 cm
Toilet height	35 cm
Open front toilet seat	YES
Support handles	Missing
Flexible shower on the side of the toilet	YES
Free space on the sides of the toilet	left Above 90 cm right 15 cm frontal Above 90 cm
Electric doorbell/telephone	YES



Washbasin with space underneath for wheelchair	53 cm
Height from the ground lower edge mirror	114 cm
Baby changing table	NO
	
<b>Accessible shower</b> available for guests with reduced mobility	YES separate from the toilet room
Access to the shower room if separated from the toilet room	by ramp length 15 cm, width 100 cm slope 15.6%
Useful width of the door/entrance gate if separated from the toilet room	Above 90 cm
Type of shower	open type
Floor-level shower	YES
Shower chair	missing
Support handle	missing
Presence of shower head or sliding rails	Fixed shower head
Electric doorbell/telephone	NO

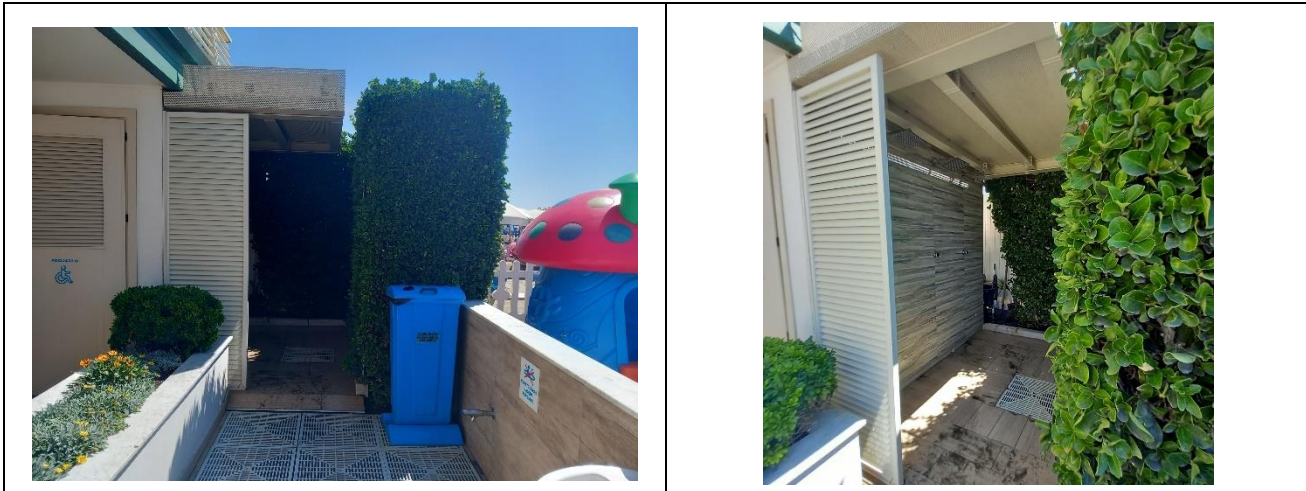



**Changing room**

Changing room accessible to guests with reduced mobility available	YES
Access to the premises	flat
Useful width of door/entrance gate	83 cm
Locker room size	width 100 cm and depth 200cm
Presence of cot	NO
Coat rack height from the ground	Not detected





## Beach

Type of beach	sand
Beach access	by ramp length 300 cm, width 200 cm slope 2.3%
Walkway to reach the umbrellas	YES
Type of walkway	PVC
Walkway width	100 cm
	
Removable Platform between the walkway and the umbrella station to facilitate the passage and parking wheelchair	YES
Amphibious beach chair available for helping people with reduced mobility to enjoy swimming (owned by the establishment or by association)	YES

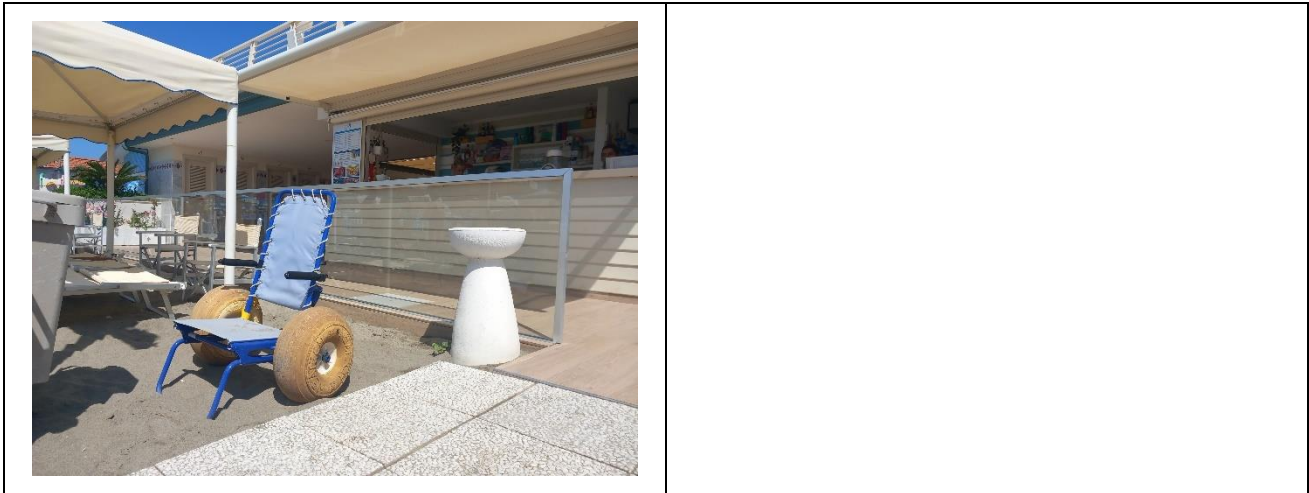

**Children's play area**

<p>Children's play area</p>	<p>inaccessible to children with reduced mobility due to sandy bottom</p>
<p>There are games for children with reduced mobility</p>	<p>NO</p>



**Swimming pool**

The property has a swimming pool	YES
Access to the swimming pool	flat
Useful width of the entrance gate	Above 90 cm
Access to the pool	with ladder
Bathing aids for guests with reduced mobility	Anfibia ready

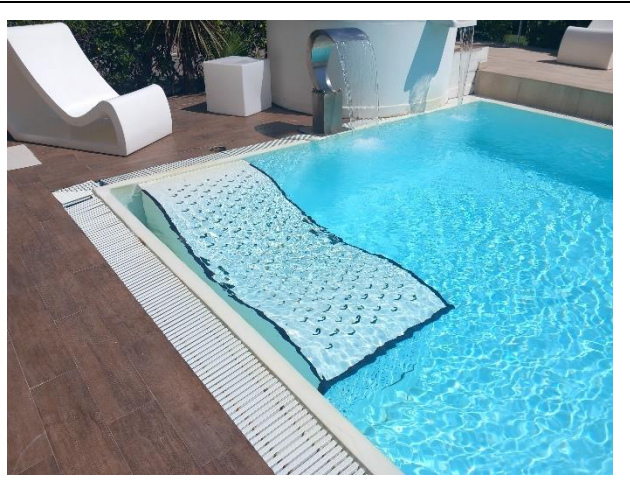
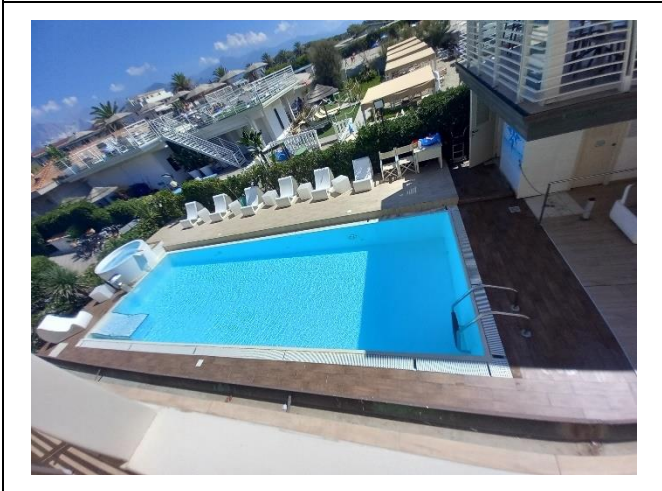



**Medical practices/healthcare facilities**

Hospitals near the property	N.O.A. Nuovo Ospedale Apuane Marina di Massa By Enrico Mattei, 21 telephone 0585 4931
Other healthcare facilities	Emergency Medical Service By Giovan Pietro, 1 54033 CARRARA (MS) TELEPHONE; 0585 885452 District Presidium of Carrara Center - USL Tuscany northwest Piazza Sacco e Vanzetti, 5 - 54033 Carrara (MS) UO Nephrology ASL 1 Massa Carrara telephone 0585/498225 dialysis service ON HOLIDAYReferent: Erika Biassoli Tel. 0585/498225

TESTED BY: **Handy Superabile Social Promotion Association** in summer 2024